

Assembly/Operating Instructions with Parts List

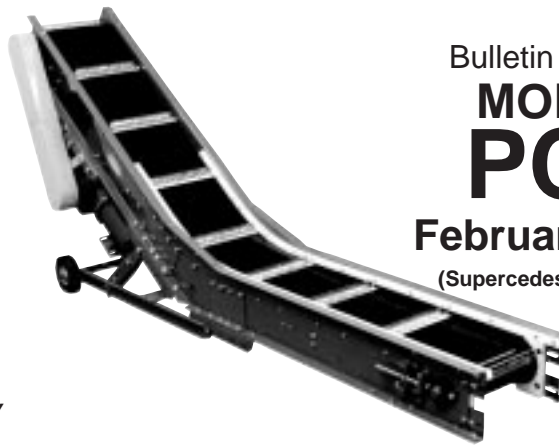

Bulletin No. 487

**MODEL
PCX**

February, 2001

(Supersedes April, 1998)

RECOMMENDED SPARE PARTS LIST HIGHLIGHTED IN GRAY

MODEL "PCX" LOW PROFILE PARTS CONVEYOR

UNCRATING—Before uncrating, check the number of items received against the bill of lading. Examine condition of equipment to determine if any damage occurred during shipment. **NOTE:** *Some optional equipment may be fastened to the conveyor. After uncrating, check to see that these parts (or any loose foreign pieces which may have dropped into the conveyor) are removed.*

INSTALLATION INSTRUCTIONS— The Model "PCX" is shipped completely assembled. Adjust the portable support to the desired height. Move conveyor into place and connect electrical controls to power source.

Important: *Electrical controls should be installed and wired by a qualified electrician. Wiring information for the motor and controls are furnished by the equipment manufacturer.*

TRACKING THE BELT— All conveyors are assembled and run at the factory and the belt is tracked before shipment. In the event the belt does not track, make sure the drive and tail pulley are square with the bed. To check squareness, measure distance from end of the conveyor to center of pulley shafts, both sides. Track belt by adjusting screw take-ups at the tail pulley when belt is running toward drive end. If belt runs to the right side of the tail pulley, move take-up out on right side. If belt runs to the left side, move take-up out on left side.

BELT TENSION— To insure maximum-rated load capacity on conveyor belt, maintain enough tension so that drive pulley will not slip under belt when carrying full load. Screw take-ups on tail pulley will tighten belt. Because of climactic conditions or after lengthy service, it may be necessary to shorten conveyor belt and relace to maintain required tension.

DRIVE CHAIN ADJUSTMENT— This can be adjusted by loosening speed reducer bolts and moving reducer back with 3/8 in. take-up screw on base plate. Tighten speed reducer bolts before running. Remove a link out of chain if limit of adjustment is reached.

LUBRICATION— Drive and tail pulleys have sealed bearings greased for life. Speed reducer is filled with SAE 90 (use lighter in freezing temperature) gear lubricant and sealed at the factory. If reducer runs too hot, check oil level. Reducer must be removed for refilling.

Chain Lubrication Recommendations:

- For best results, always use a brush to generously lubricate chain.
- For best results, always use a brush to generously lubricate chain.
- Recommended lubricant: 30W Mobile 1 Synthetic.
- Lubricate all chain immediately after installation.

Once Normal Operating Conditions have been established:

1. . . Schedule first preventive maintenance operation to take place after 50 hours of operation.
2. . . Evaluate chain lubrication.
3. . . If chain appears to be lubricated adequately, lubricate chain and schedule next preventative maintenance operations to take place after 100 hours of operation.
4. . . Repeat steps 2 and 3 adding 50 hour increments to preventative maintenance schedules until such time chain appears to need lubrication.
5. . . Set routine preventative maintenance schedules for the last period of time in which chain was lubricated adequately.
6. . . If normal operating conditions are altered, repeat entire procedure beginning with step 1.

● Model PCX Parts Drawing

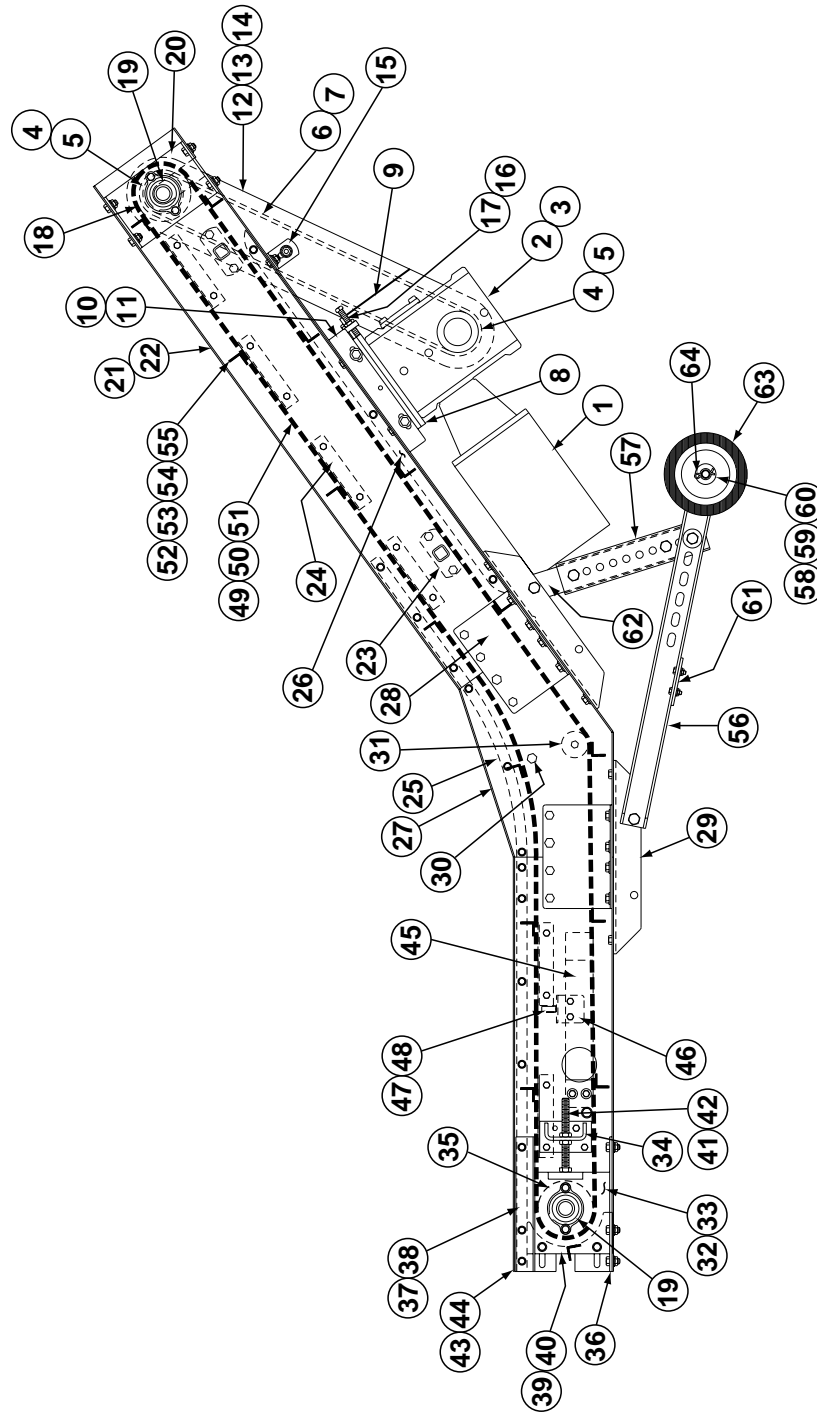

MAINTENANCE— To insure that your conveyor runs with a minimum amount of down time, some simple preventive maintenance steps should be taken. Check and adjust the following if necessary:

1. Check Daily—Belt tracking and tension
2. Check Weekly—Chain sprockets, loose set screws
3. Check Monthly—Pulleys, bearings

● Model PCX Parts List

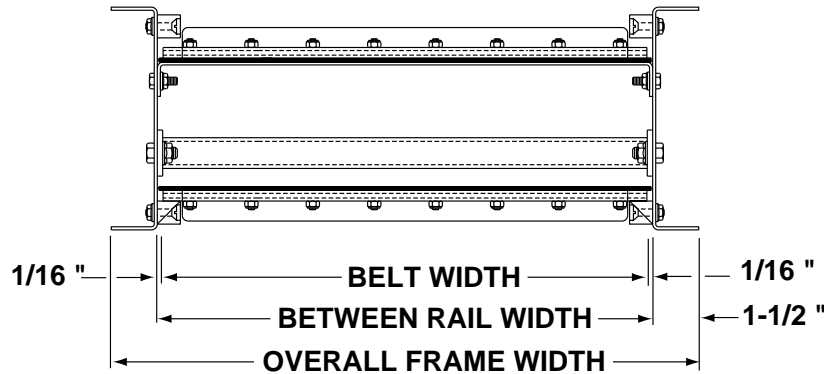

RECOMMENDED SPARE PARTS LIST HIGHLIGHTED IN GRAY

Belt Width	12"	18"	24"
OAW	15-1/8"	21-1/8"	27-1/8"

Ref. No.	Part No.	Description
1	—	Motor—CFace
—	030.7134	1/2 HP—230/460VAC—3PH.—60Hz.—TEFC
—	030.7244	3/4 HP—230/460VAC—3PH.—60Hz.—TEFC
—	030.7324	1 HP—230/460VAC—3PH.—60Hz.—TEFC
2	R-00153-83R	4AC Speed Reducer—RH—83:1 Ratio
3	052.145	Coupling Kit—Motor to Reducer (1/2 to 1 HP)
4	028.115	Sprocket—Reducer, 50B15 x 1 in. Bore
5	090.203	Shaft Key—1/4 in. Sq. x 1 in. Long
6	029.101	#50 Riveted Roller Chain
7	029.201	Connector Link—#50 Roller Chain
8	B-05279	Motor Base Assembly (Specify Belt Width)
9	B-05281	Deflection Shield (Specify Belt Width)
10	B-05540	Motor Base Support Angle—LH
11	B-05545	Motor Base Support Angle—RH
12	B-03723	Chain Guard Front Plate
13	B-09409	Chain Guard Back Plate
—	040.3112	Hex Bolt 3/8-16x3-1/2" Lg.
14	041.919	Acorn Nut—3/8-16
15	B-09448	Mounting Clip—Chain Guard
16	040.307	Take-Up Bolt—3/8-16 x 2-1/4 in. long
17	041.300	Hex Jam Nut—Heavy—3/8-16
18	B-03715	4 in. Dia. Drive Pulley (Specify Belt Width)
19	010.0021	2-Bolt Flange Bearing—1 in. Bore
20	B-16068	Bearing Mounting Channel
21	—	Incline Channel—LH
—	B-08113-L	45 in. Long Incline Section
—	B-08111-L	54 in. Long Incline Section
—	B-08112-L	66 in. Long Incline Section
22	—	Incline Channel—RH
—	B-08113-R	45 in. Long Incline Section
—	B-08111-R	54 in. Long Incline Section
—	B-08112-R	66 in. Long Incline Section
23	B-01290	Bed Spacer Assembly (Specify Belt Width)
24	B-06381	Slider Plate (Specify Belt Width)
25	—	Belt Guide
—	B-16067-030	30 in. Long Feeder Section
—	B-16067-042	42 in. Long Feeder Section
26	—	Return Guide Wearstrip
—	B-16070-045	45 in. Long Incline Section
—	B-16070-054	54 in. Long Incline Section
—	B-16070-066	66 in. Long Incline Section
27	B-03701	Angle Connection Channel
28	B-03710	Splice Plate
29	B-03730	Wheel Attachment Angle
30	B-12443	Threaded Section Spacer (Specify Belt Width)

Ref. No.	Part No.	Description
31	B-01982	1.9 dia. Galvanized Roller (Specify BR)
32	B-16057-L	Take-Up Plate—LH
33	B-16057-R	Take-Up Plate—RH
34	B-16060	Take-Up Bracket Assembly
35	B-16061	4 in. Dia. Tail Pulley (Specify Belt Width)
36	B-16063	Bottom Guide
37	B-16064	Top Guide
38	B-16065	Top Guide Spacer
39	B-16066-L	Tail Pulley Wearstrip Guide—LH
40	B-16066-R	Tail Pulley Wearstrip Guide—RH
41	040.4085	Take-up Bolt—1/2-13 x 5 in. long
42	041.201	Hex Jam Nut—1/2-13
43	—	Feeder Channel—RH
—	B-03702-030	30 in. Long Feeder Section
—	B-03702-042	42 in. Long Feeder Section
44	—	Feeder Channel—LH
—	B-05273-030	30 in. long Feeder Section
—	B-05273-042	42 in. long Feeder Section
45	B-06349	Belt Scraper (Specify Belt Width)
46	B-06383	Brush Clip Assembly
47	B-06257	Belt Brush (Specify Belt Width)
48	049.301	Self-Tapping Screw—#8 x 1/2 in. long
49	—	Belt, Black Trackmate 533 COS-PVC
—	064.654	12 in. wide
—	064.657	18 in. wide
—	064.660	24 in. wide
50	—	U3 Clipper Unibar Lacing (Specify Length)
51	—	#13 Lacing Pin (Specify Length)
52	B-04686	Metal Cleat (Specify Belt Width)
53	042.2072	Flat Head Screw—#10-24 x 5/8 in. Long
54	041.802	Nylon Locknut—#10-24
55	099.108	Countersunk Washer
56	B-03731	Wheel Mount Channel
57	B-03733	Outside Wheel Support
58	B-03734	Wheel Axle (Specify Belt Width)
59	B-03735	Wheel Axle Housing (Specify Belt Width)
60	B-03806	Wheel Axle Spacer
61	B-03851	Cross Brace (Specify Belt Width)
62	B-03732	Inside Wheel Support
63	019.100	Rubber Wheel—6 in. Dia. x 5/8 in. Bore
64	090.102	Cotter Pin—3/16 in. Dia. x 1-1/2 in. Long



HYTROL CONVEYOR COMPANY, INC.
2020 Hytrol Drive
Jonesboro, Arkansas 72401

Phone: (870) 935-3700

www.hytrol.com

EFFECTIVE FEBRUARY, 2001

Printed in the USA 2/01 by Landmark Graphics

© COPYRIGHT 2001-HYTROL CONVEYOR CO., INC.